

ACCESS

Located close to the major transport hubs and airports, Nara is easily accessible from Japan's major cities and overseas.

Nara Prefectural Convention Center is about a 10-minute walk from the nearest station (Kintetsu Shin-Omiya Station). By the direct airport limousine bus, it takes about 100 minutes from Kansai International Airport making it easy to access from overseas.

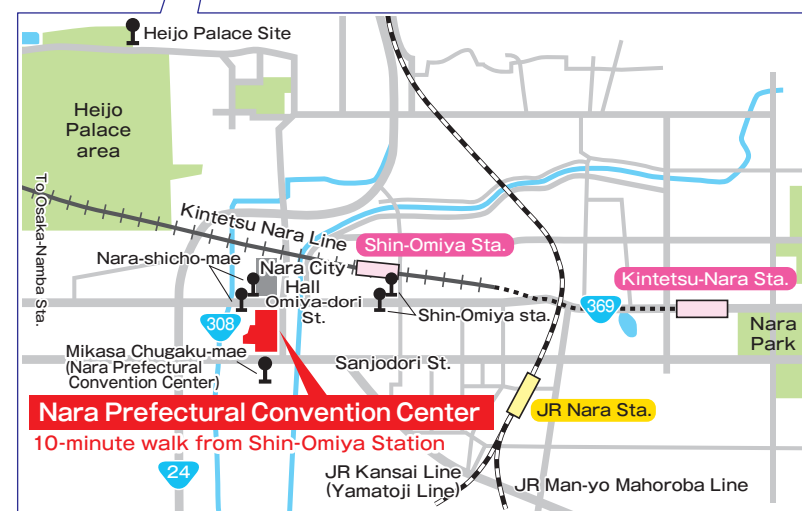
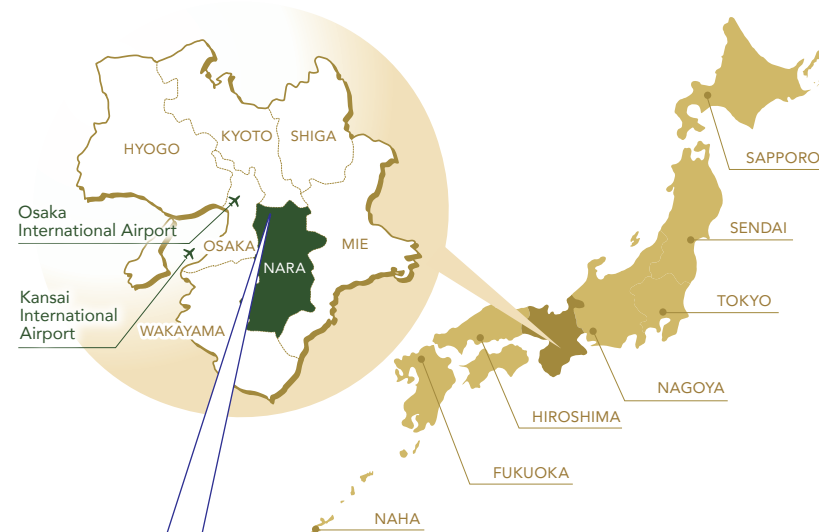

By Plane

From Osaka International Airport (Itami)	About 60 min. by airport bus	Direct access	NARA Prefectural Convention Center
From Kansai International Airport	About 100 min. by airport bus	Direct access	

By Train

From Kyoto Sta.	About 45 min. (Kintetsu)	Kintetsu Shin-Omiya Sta.	About 10 min. on foot	NARA Prefectural Convention Center
From Osaka-Namba Sta.	About 35 min. (Kintetsu)			
From Tennoji Sta.	About 35 min. (JR)	JR Nara Sta.	About 15 min. on foot	
From Shin-Osaka Sta.	About 60 min. (JR)		About 8 min. by bus About 3 min. by taxi	

Parking / Bicycle Parking

Parking Space 400 cars *The first hour free *The maximum fee: 1,000 yen for every 24 hours

Bicycle Parking Free

Underground Parking

Opening hours: 0:00-24:00 (24 hours a day)
Charges: 100 yen/30 minutes (8:00-24:00)
100 yen/60 minutes (0:00-8:00)

Ground Parking

Opening hours: Entry between 8:30-21:00
Exit between 8:30-22:00
Charges: 100 yen/30 minutes (8:00-24:00)
100 yen/60 minutes (0:00-8:00)

Space
128 bicycles 24 motorbikes

Places to visit near Nara Prefectural Convention Center

The Center is located in the middle of Nara city between Nara Park and Heijo Palace Site, full of UNESCO World Heritage sites and well-preserved temples and shrines.



Inquiry

For Reservations Business hours: 9:00-17:00

Nara Prefectural Convention Center

TEL: +81-742-32-2290 FAX: +81-742-32-2291 E-MAIL: info@nara-cc.jp

Closed: Mondays (if a public holiday falls on Monday, then the next weekday)

From January 1 to 4 and December 28 to 31



MICE Promotion Office,
Tourism Bureau of
Nara Prefecture

TEL: +81-742-27-8479 FAX: +81-742-27-1065

More info www.nara-cc.jp/english

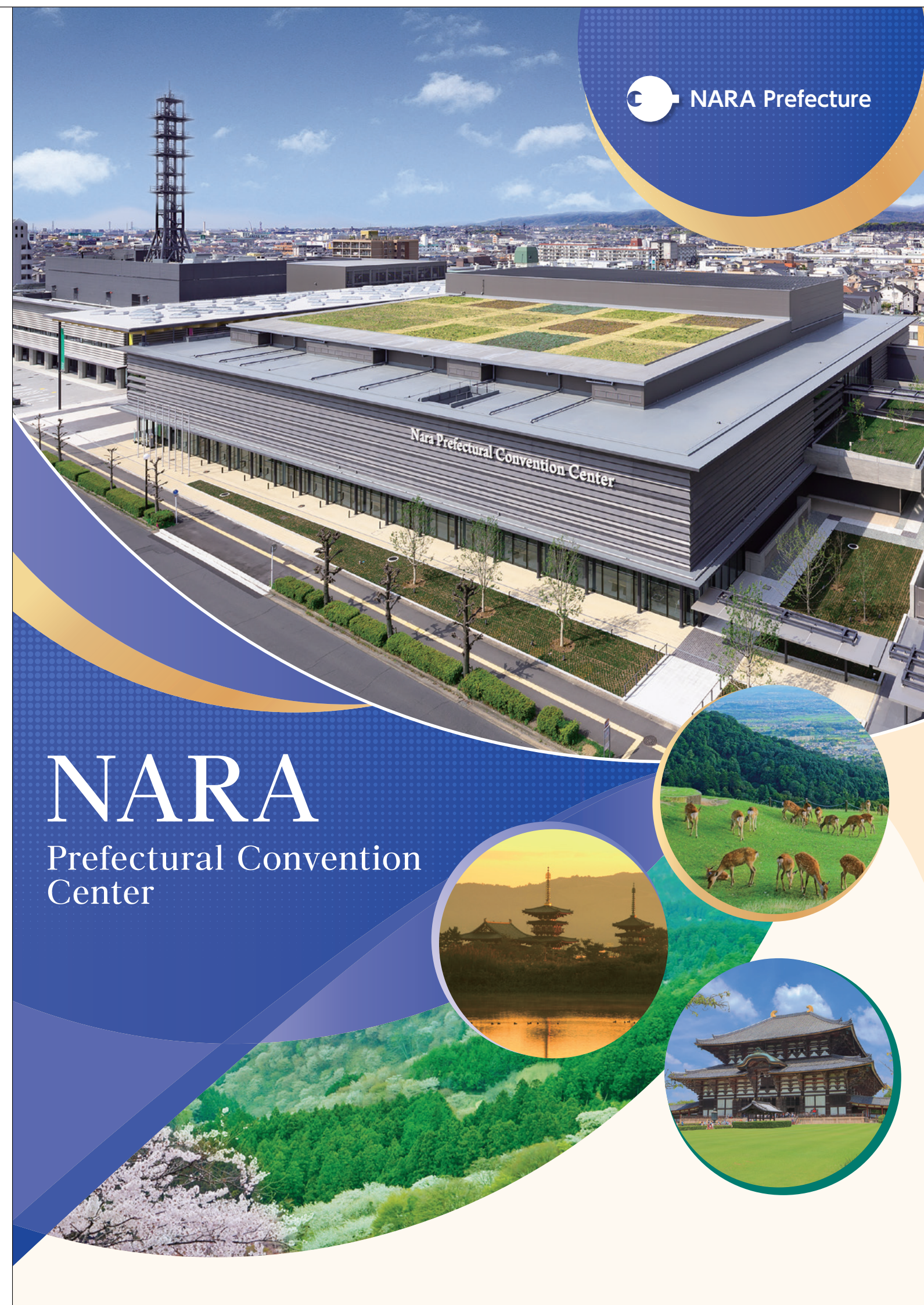

NARA Prefecture

NARA

Prefectural Convention Center



The place where pleasant landscapes meet functional facilities

Have a memorable event here, where Nara's unique characteristics are integrated into its design and feature.

Various art pieces made by local artisans

Handcrafted furniture using local wooden materials are placed throughout the complex, adding cultural richness to the place.

Tourism Promotion Facility

This public facility is built for the purpose of promoting tourism in Nara, offering a variety of locally-produced food and products.

Shops

- NARA TSUTAYA BOOKS
- Starbucks
- Family Mart Convenience Store
- Nakagawa Masashichi Shoten Shop



Tempyo Hall



Bus Terminal



Tempyo Square



JW Marriott Hotel Nara



NHK New Nara Broadcasting Station

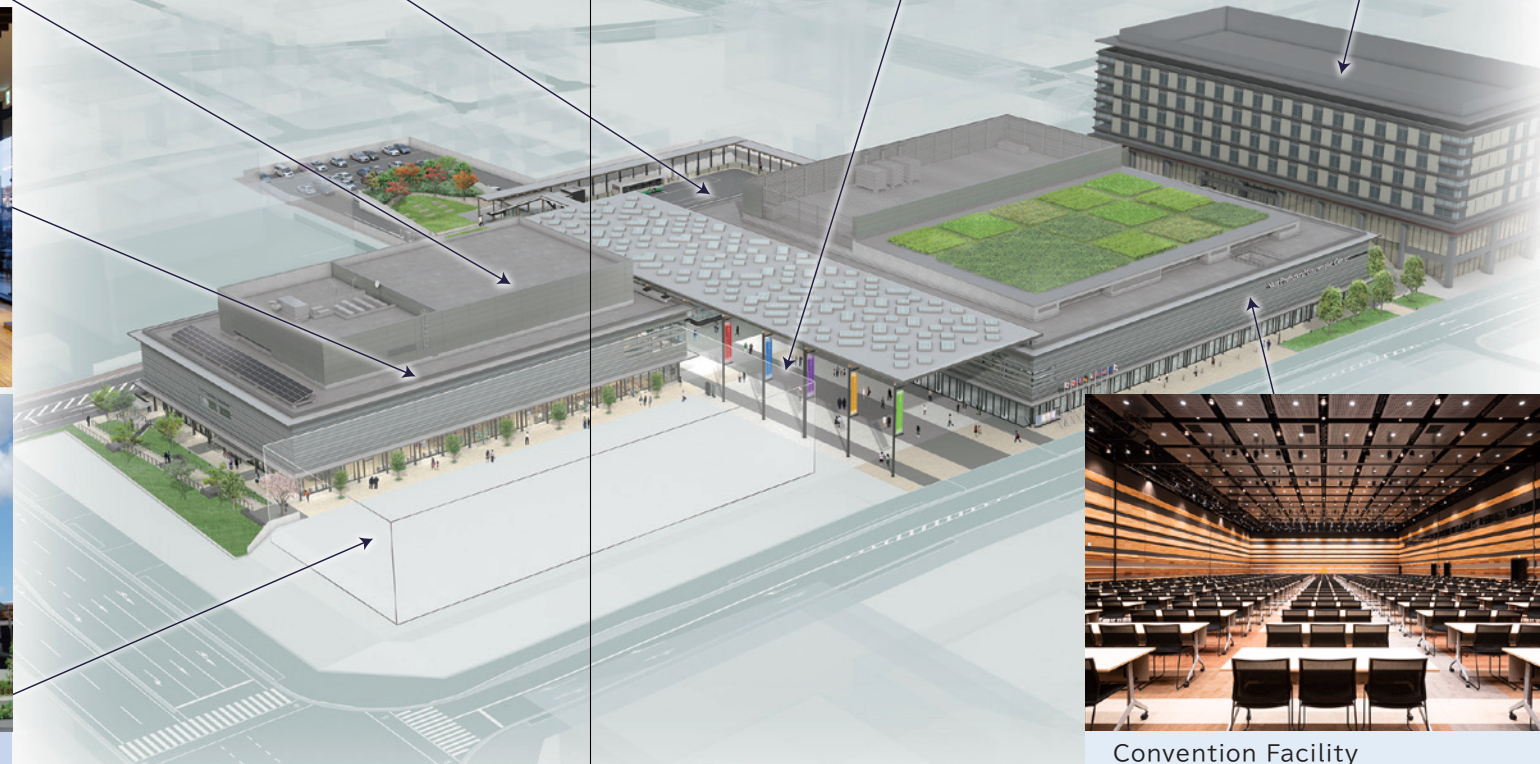

Convention Facility

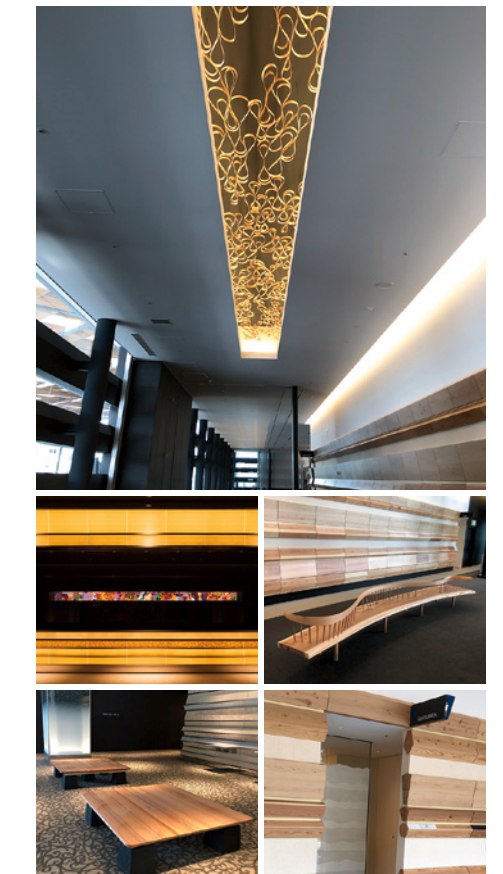

Overview of Nara Prefectural Convention Center

Classification	Details and usage examples
Location	691-1, 1-chome, Sanjo-ji, Nara city
Number of floors	Underground B2 & B1, First Floor and Second Floor
Convention Facility	1st Floor: Convention Hall, Meeting Rooms 101-108, Waiting Rooms 2nd Floor: Meeting Rooms 201-206, Waiting Rooms (Suitable for international conferences, academic conferences, seminars, exhibitions etc.)
Tempyo Square	Covered Outdoor area (Suitable for Marché, Lunchtime concert etc.)
Tourism Promotion Facility	1st & 2nd Floors: Food & drink and shops (Restaurants, cafés and shops selling local specialties and products etc.)
Tempyo Hall	2nd Floor: <Theater Hall> (Music concerts & performances, movies, exhibition events etc.)
Parking/Bus Terminal	Parking space up to 400 cars (B2, B1 & Ground Floor), Bicycle Parking Bus Terminal (Limousine bus stops and more) and Waiting Rooms etc.

Floorplan

1F

To
JW Marriott Hotel
Nara

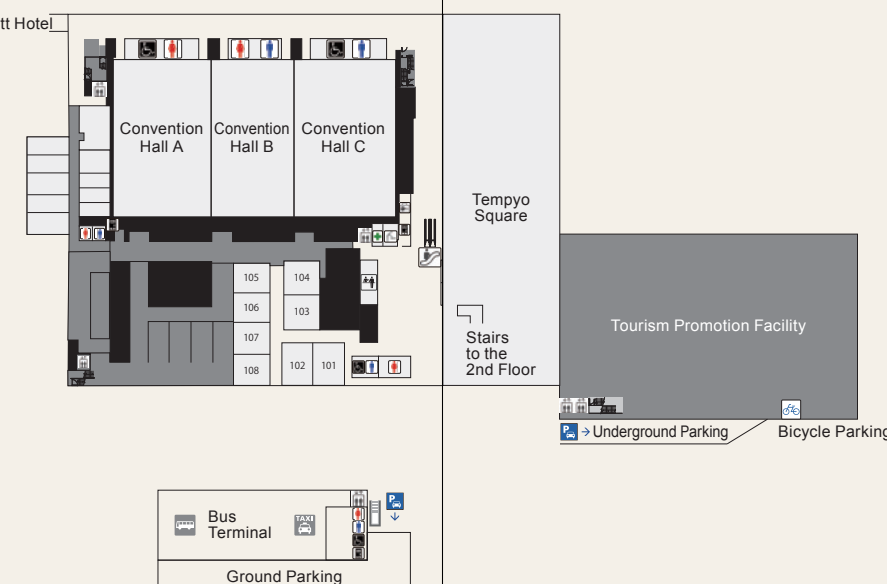

2F

To
JW Marriott Hotel
Nara

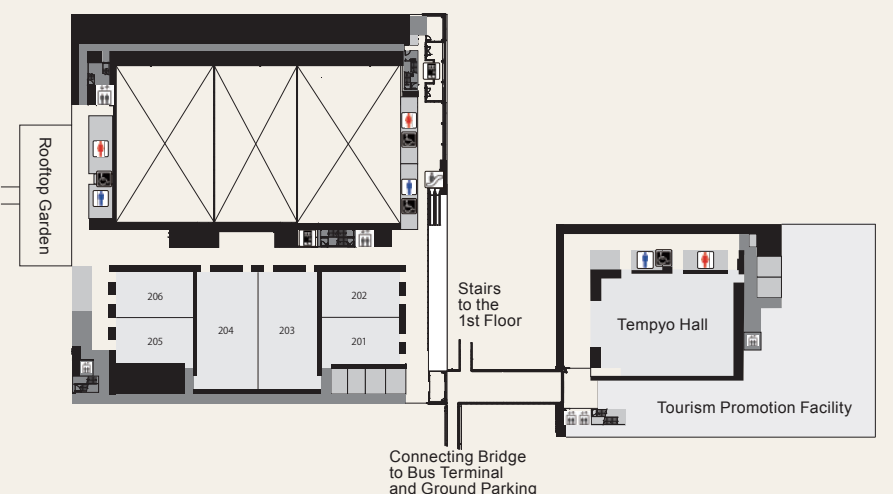

Convention Hall



Expansive space of 2,100m² with a ceiling height of 9.9m
 Suitable for exhibitions, academic meetings, lectures and parties

● Dividable into three halls with soundproof folding retractable walls ● This flat space can be tailored to a range of events

Room Rates		(JPY-Tax inclusive)					
		Morning (9:00~12:00)	Afternoon (13:00~17:00)	Morning/ Afternoon (9:00~17:00)	Evening (18:00~21:30)	Afternoon/ Evening (13:00~21:30)	All Day (9:00~21:30)
Convention Hall A or C	Weekend/ Holiday	125,100	166,800	291,900	166,800	333,600	417,000
	Weekday	104,250	139,000	243,250	139,000	278,000	347,500
Convention Hall B	Weekend/ Holiday	104,200	139,000	243,200	139,000	278,000	347,400
	Weekday	86,850	115,800	202,650	115,800	231,600	289,500
Convention Hall A・B・C (Combined)	Weekend/ Holiday	354,400	472,600	827,000	472,600	945,200	1,181,400
	Weekday	295,350	393,800	689,150	393,800	787,600	984,500

Facility Overview	
Area	Combined: Approx. 2,100m ² Divided (into three): [A]: Approx. 730m ² [B]: Approx. 600m ² [C]: Approx. 770m ²
Capacity	Combined: Theater 2,000/ Classroom 1,155/ Banquet 100 round tables (Standing)/ 96 round tables (Seated) Divided: [A] : Theater 700/ Classroom 360 [B] : Theater 521/ Classroom 300 [C] : Theater 700/ Classroom 360
Ceiling height	9.9m

Layout plans

Theater Style [Combined/Divided]

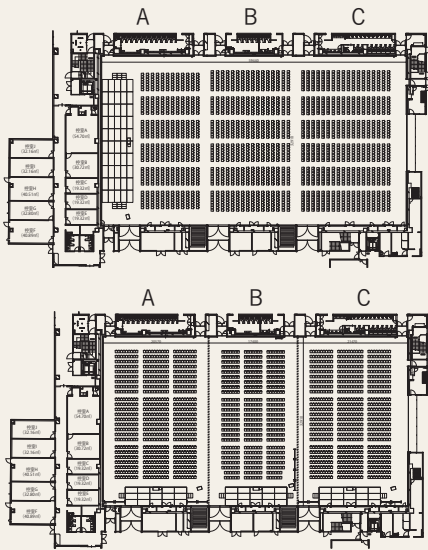

Classroom Style [Combined/Divided]

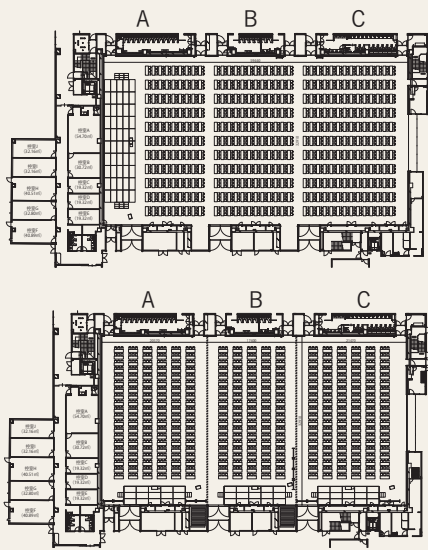

Banquet Style [Standing/Seated]

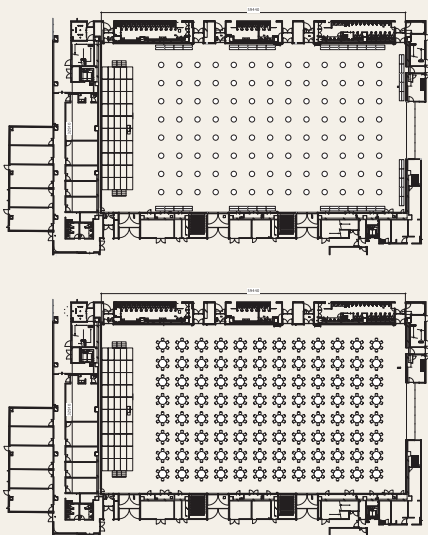

Meeting Rooms 201~206



High-quality functional meeting rooms that meet diverse needs

- Various sizes of meeting space available from 150m² to 300m² and 600m²
- Ideal for large-scale meetings, committee meetings, seminars and more

Facility Overview

Meeting Rooms 201/202/205/206	
Area	2 Rooms Combined: Approx. 320m ² 1 Room: Approx. 160m ² each
Capacity	2 Rooms Combined: Theater 242/ Classroom 135 1 Room: Theater 150/ Classroom 72
Ceiling height	4.5m
Meeting Rooms 203/204	
Area	2 Rooms Combined: Approx. 630m ² 1 Room: Approx. 315m ² each
Capacity	2 Rooms Combined: Theater 528/ Classroom 252 1 Room: Theater 270/ Classroom 156
Ceiling height	4.5m

Room Rates

		(JPY-Tax inclusive)						
		Morning (9:00~12:00)	Afternoon (13:00~17:00)	Morning/ Afternoon (9:00~17:00)	Evening (18:00~21:30)	Afternoon/ Evening (13:00~21:30)	All Day (9:00~21:30)	
Meeting Room 201 or 202	Weekend/ Holiday	29,700	39,600	69,300	39,600	79,200	99,000	
	Weekday	24,750	33,000	57,750	33,000	66,000	82,500	
Meeting Room 203 or 204	Weekend/ Holiday	59,400	79,200	138,600	79,200	158,400	198,000	
	Weekday	49,500	66,000	115,500	66,000	132,000	165,000	
Meeting Room 205 or 206	Weekend/ Holiday	29,700	39,600	69,300	39,600	79,200	99,000	
	Weekday	24,750	33,000	57,750	33,000	66,000	82,500	

Layout plans

Combined [Theater/ a total of 3 rooms]

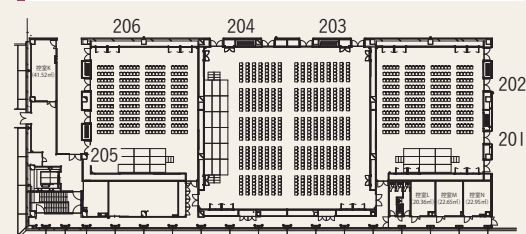

Divided [Theater/ a total of 6 rooms]

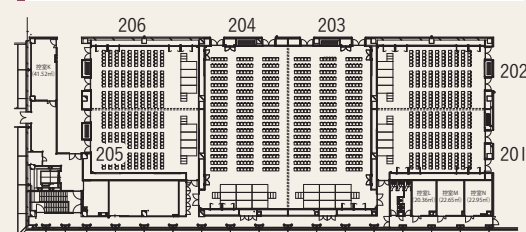

Meeting Rooms 101~108



Suitable for meetings, seminars and trainings

- Also suitable as waiting rooms for large events

Facility Overview

Meeting Rooms 101~108	
Area	2 Rooms Combined: Approx. 100m ² 1 Room: Approx. 50m ²
Capacity	2 Rooms Combined: Theater 90 1 Room: Theater 45
Ceiling height	3.0m

Room Rates

		(JPY-Tax inclusive)						
		Morning (9:00~12:00)	Afternoon (13:00~17:00)	Morning/ Afternoon (9:00~17:00)	Evening (18:00~21:30)	Afternoon/ Evening (13:00~21:30)	All Day (9:00~21:30)	
Meeting Room 101~108 each room	Weekend/ Holiday	5,940	7,920	13,860	7,920	15,840	19,800	
	Weekday	4,950	6,600	11,550	6,600	13,200	16,500	

Layout plans

Combined [Theater/ a total of 4 rooms]

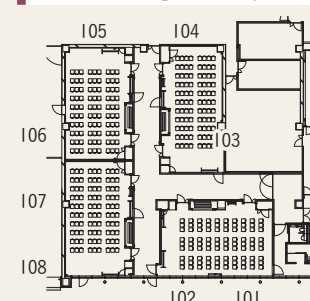

Divided [Theater/ a total of 8 rooms]

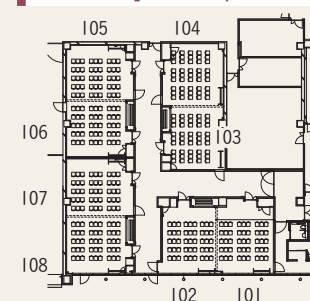

Tempyo Hall



Approx. 600m² Theater Hall / Highly versatile theater space with flexible tiered seats

- Equipped with the latest cinema screen, perfect for film screenings
- Suitable for performances and concerts
- With its automated retractable seats, the hall can be used as a flat space

Facility Overview

Area	Approx. 600m ²
Capacity	On the flat space: Theater 504 Tiered seating: Theater 476
Ceiling height	8.0m

Room Rates

		(JPY-Tax inclusive)						
		Morning (9:00~12:00)	Afternoon (13:00~17:00)	Morning/ Afternoon (9:00~17:00)	Evening (18:00~21:30)	Afternoon/ Evening (13:00~21:30)	All Day (9:00~21:30)	
Tempyo Hall	Weekend/ Holiday	118,800	158,400	277,200	158,400	316,800	396,000	
	Weekday	99,000	132,000	231,000	132,000	264,000	330,000	

Tempyo Square



Spacious covered outdoor space ideal for open-air events

- Square shaped event space of over 1,000m²
- The whole area is covered, accommodating all weather conditions
- Ideal for exhibitions, markets and food events

Facility Overview

Area	Combined: Approx. 1,270m ² Divided (into four): [A] : Approx. 375m ² [B] : Approx. 486m ² [C] : Approx. 265m ² [D] : Approx. 146m ²
Ceiling height	13m

Rental Rates

		(JPY-Tax inclusive)						
		Morning (9:00~12:00)	Afternoon (13:00~17:00)	Morning/ Afternoon (9:00~17:00)	Evening (18:00~21:30)	Afternoon/ Evening (13:00~21:30)	All Day (9:00~21:30)	
Tempyo Square (Per 1m ²)	Weekend/ Holiday	66	66	132	132	198	264	
	Weekday	55	55	110	110	165	220	

Layout plans

